

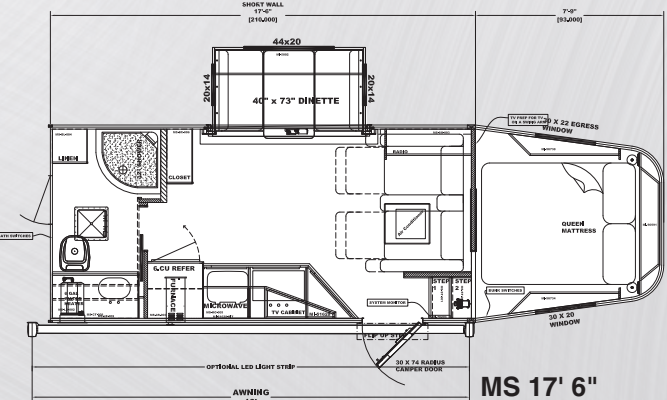

# Merhow Motorsport

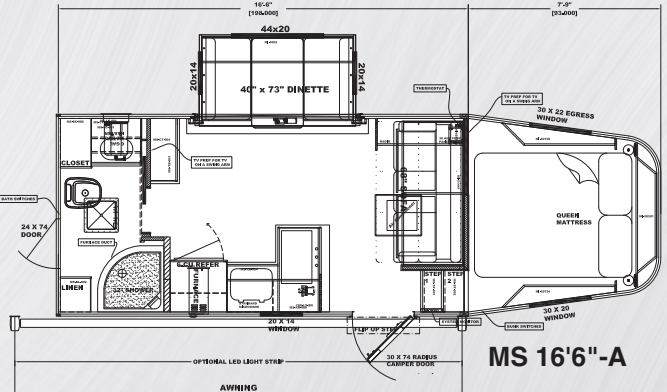

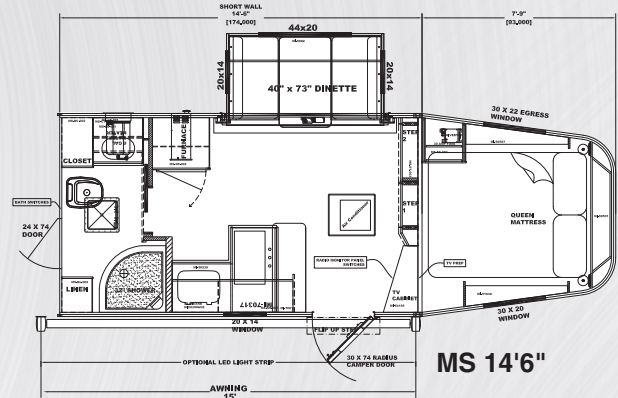
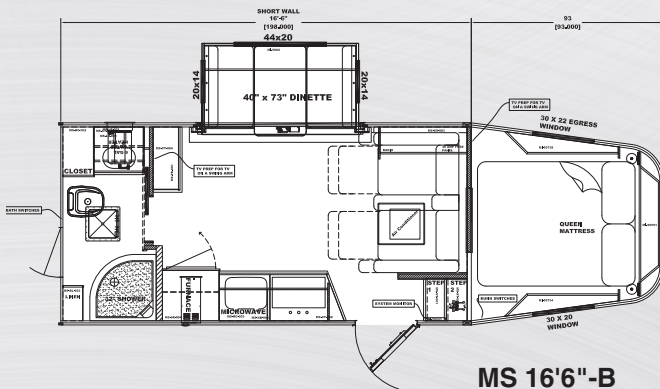
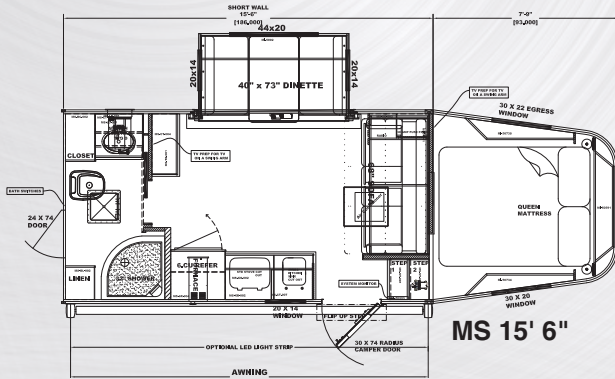
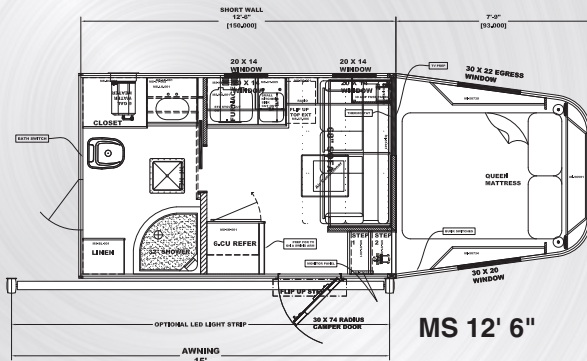
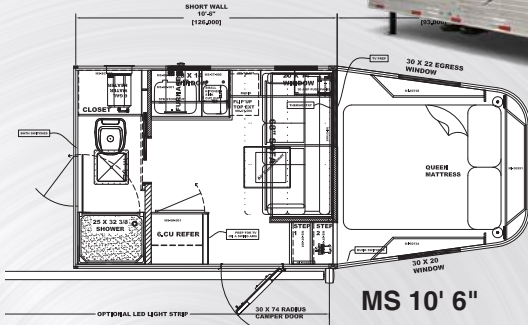

## STANDARD SPECIFICATIONS:

- 8 YEAR STRUCTURAL WARRANTY
- 2 YEAR MERHOW LQ WARRANTY
- 7'6" TALL, 8' WIDE
- 4" CROSS MEMBERS COMMONLY ON 16" CENTERS
- EXTERIOR WHITE ALUMINUM SKIN .040
- EXTRUDED ALUMINUM FLOOR
- ONE PIECE (SEAMLESS) ALUMINUM ROOF
- SINGLE HYDRAULIC JACK
- JIFFY JACK
- FRONT HITCH WITH ADJUSTABLE COUPLER 2 5/16
- ALL ALUMINUM SIDE WALL POSTS
- (4) LED LIGHTS (2) EACH SIDE IN CARGO AREA IN BESSEL METAL
- BREAK AWAY SAFETY SWITCH WITH BATTERY
- °DEXTER EZ-LUBE TORSION AXLES
- LED BRAKE AND RUNNING LIGHTS (2) SETS
- (2) SETS OF STOP/TAIL LIGHTS
- 14 X 14 CRANK UP VENT IN CARGO AREA
- ALUMINUM WALL THAT DIVIDES THE LQ AREA FROM THE CARGO AREA WALK THRU DOOR FROM THE LQ AREA TO THE CARGO AREA CAMPER DOOR WITH SCREEN DOOR INTO LQ AREA
- ALUMINUM LP TRAY SUPPORTS UNDER BUNK AT THE RISER WALL ONE KITCHEN WINDOW
- EGRESS WINDOWS IN BUNK AREAS
- CARGO AREA WALLS INSULATED AND LINED WITH WHITE ALUMINUM ACCESS DOOR IN CARGO AREA
- 6 GALLON GAS/ELECTRIC DSI WATER HEATER
- PLASTIC FOOT FLUSH TOILET
- 41 GALLON FRESH WATER TANK
- 31 GALLON BLACK TANK
- 31 GALLON GRAY TANK
- OUTSIDE WATER SPIGOT
- SEWER HOSE & HOLDER
- TANK MONITOR SYSTEM
- 19,000 BTU FURNACE
- 13,500 BTU AIR CONDITIONER (9' - 14' MODELS)
- 15,000 BTU AIR CONDITIONER (16'-18' MODELS)
- DUCTED A/C W/HEAT STRIP
- DIGITAL CONTROL THERMOSTAT FOR HEATING & COOLING
- SATELLITE INLET
- TV ANTENNA W/BOOSTER
- 3" CROWN MOLDING IN MAIN LQ & BUNK
- SOLID WOOD WINDOW RINGS

- SOLID WOOD CABINETRY
- LINOLEUM FLOORING
- SOLID SURFACE COUNTER TOPS
- OVERHEAD CABINETS IN THE BUNK
- DRAWERS IN KITCHEN
- MEDICINE CABINET AND MIRROR
- SINK W/VANITY – DEPENDING ON FLOOR PLAN
- HOLLOW CORE BATHROOM DOOR
- SOFT TOUCH WALLS IN BATHROOM AND LQ
- PANEL WALLS IN SLIDE OUT
- PLEATED SHADES ON ALL WINDOWS
- SOFT TOUCH ON ENTRANCE DOOR INTERIOR & PASS THRU DOOR
- LIGHT UNDER OVERHEAD CABINET
- 3 WAY SWITCH FOR BUNK CEILING LIGHTS
- BUNK CARPETED
- ONE PIECE FIBERGLASS SHOWER W/ GLASS DOOR
- WATER SAVER SHOWER FAUCET W/PAUSE CONTROL
- CHROME COLORED FAUCETS & TOWEL BARS & T.P. HOLDER
- POWER LIFT ROOF VENT IN BATHROOM – MANUAL CRANK
- MICROWAVE
- LIGHTED/VENTED RANGE HOOD
- DUAL 20# LPG TANKS W/REGULATOR
- 2 BURNER STOVE W/LID
- DUAL DEEP CYCLE MARINE BATTERIES
- 30 AMP POWER CONVERTER
- EXTERIOR 12V PORCH LIGHT
- LIGHTED GRAB HANDLE
- ONE GFI 110 VOLT OUTLET IN CARGO AREA
- 6 CUBIC REFRIGERATOR
- RAISED PANEL REFER FRONT

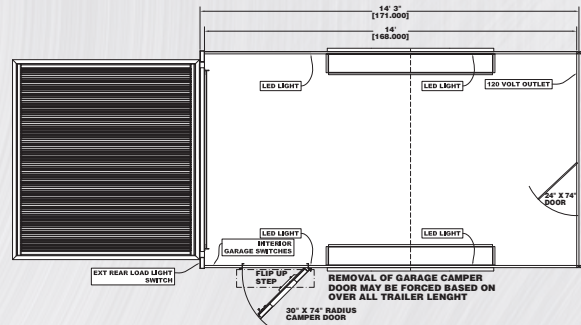

MODEL	AXLE SIZE & TIRES	SEATING
8M10__	7,000 lb. Axles, 16E TIRES	68" SOFA
8M12__	7,000 lb. Axles, 16E TIRES	68" SOFA
8M14__	7,000 lb. Axles, 16E TIRES	40" DINETTE
8M15__	7,000 lb. Axles, 16E TIRES	40" DINETTE & 68" SOFA
8M16__A	7,000 lb. Axles, 16E TIRES	40" DINETTE & 68" SOFA
8M16__B	7,000 lb. Axles, 16E TIRES	40" DINETTE & THEATER
8M17__	7,000 lb. Axles, 16E TIRES	40" DINETTE & THEATER

\*FORCED AXLE UPGRADES BASED ON UNIT SIZE



**Office - 269.483.0010**  
**Fax - 269.483.0030**  
**[www.merhow.com](http://www.merhow.com)**

DEALER